

## Waste and Recycling Services Policy

<b>Reference Number:</b>	Section 10 No. 03
<b>Responsible Department:</b>	Infrastructure & Environment
<b>Related Policy/Procedure:</b>	
<b>Date of Adoption:</b>	18 July 2006
<b>Current Review Date:</b>	23 November 2021
<b>Minute Reference:</b>	IC10.1/2021
<b>Version Number:</b>	Amendment No. 8
<b>Applicable Legislation:</b>	Local Government Act, 1999
<b>Next Review Date:</b>	November 2023
<b>Review Frequency:</b>	Biennially

### 1. Purpose

This policy has been formulated to support continuous improvements to Council's waste and recycling services. This policy promotes a whole of Council response to the provision of fairly priced and environmentally responsible waste and recycling services, aligned with State Government policy, which aims to maximise the diversion of materials from landfill and into recycling streams including green organics.

### 2. Scope

This policy applies to the:

- disposal of household waste (including recyclables & green waste) via kerbside collection;
- collection of hard waste through annual collection programs and green waste through specific programs;
- disposal of e waste: and
- the operation of the Kapunda Resource Recovery Centre.

This policy does not cover illegally dumped waste that Council collects as part of its general maintenance function.

### 3. Policy Aim

The aim of this policy is to:

- Reduce the amount of waste going to landfill;
- Implement a mandatory system of kerbside waste collection for all defined areas;
- Offer a collection service to premises outside of the townships where economically viable;
- To reduce the amount of inappropriately disposed of waste;
- To offer the collection of hard, green and 'e' waste as an ongoing program; and
- Ensure Council provides resource management practices throughout its area that are consistent with the expectations of the community.

#### 4. Definitions

**MGB's** – Mobile Garbage Bins in either 140 litre or 240 litre capacity suitable for robotic arm collection vehicles;

**Kerbside Collection** – The collection of MGBs from individual properties within the townships and selected rural areas;

**Green Organics** – All types of garden matter including food waste, lawn clippings, prunings, leaves and other plant material;

**Dry co-mingled recyclables** – Includes paper, cardboard, steel and aluminum cans, milk cartons and plastic drink containers;

**Food Waste** – All types of food waste and scraps including fruit and vegetables, egg shells and dairy products, meat, bones and seafood;

**E-waste** – electronic waste such as television, computers, scanners, printers, audio equipment and other general electronic equipment as defined by Zero Waste SA;

**Hard waste collections** – The collection of materials from a residence, which would normally be too bulky or heavy to be placed into an MGB for regular kerbside collection.

#### 5. Policy Details

##### **Kerbside Collections**

Council will implement and operate a kerbside collection service throughout townships and selected rural areas of the Council. It will offer a general waste, recycling and green organics collection service.

##### **Township Collection Areas**

The Township Collection Service consists of a weekly general waste, fortnightly recycling and alternative fortnightly green organics collection.

This service is compulsory for all properties with a Land Use Code of Residential, Commercial, Industrial, **Primary Production** (with associated residence) or Other within the township boundaries (as amended from time to time) of Freeling, Greenock, Hewett, Kapunda, Roseworthy, Nuriootpa (within Light Regional Council) and Wasleys. **Appendix 12.4A** provides the maps of the Township Collection Areas.

Council will provide all residents within the Township Collection Area a 'kitchen tidy' food waste container to assist in the recycling of food waste into the green organics MGB.

Commercial & Industrial customers may opt for a 240 litre general waste service in lieu of a 140 litre general waste and 240 litre green service. A 240 litre recycling service will be provided with either service.

##### **Rural Collection Areas**

The Rural Collection Service consists of a weekly general waste and fortnightly recycling collection.

This service is compulsory for all properties with a Land Use Code of Residential, Commercial, Industrial, **Primary Production** (with associated residence) or Other within the boundaries (as amended from time to time) of Templers, Shea-Oak Log, Daveyston, Gawler Belt, Buchfelde, Seppeltsfield, Marananga and Hamilton. **Appendix 12.4B** provides the maps of the Rural Collection Areas.

It is generally considered that many of the properties outside of the Township Collection Area have available space for on-site green organics management.

#### Rural Collection on Designated Routes

This service consists of a weekly general waste and fortnightly recycling collection.

This service operates outside of the Rural and Township Collection Areas and is available to those properties where economically viable. A network of routes already exists and any extensions to these routes would be subject to Council assessment. The services are available to all Land Use Codes.

#### Rural & Township Kerbside Collection Charges

In accordance with Section 155(1)(b) of the Local Government Act, 1999, Council will raise a charge for these services. These charges are itemised in Council's Schedule of Fees and Charges and will be shown on each year's rates notice as an annual service charge.

#### Additional Services

Should an additional service be requested it will be charged at the direct multiple of that service except where the request relates to recyclables or green waste. Where this is the case then a separate charge per service will be applied as per the Service Charges in Council's Schedule of Fees and Charges.

#### Bin Supply & Configurations

All new services will have bins supplied as part of the annual service charge.

- Council shall as part of the waste services policy, supply residents with compostable Bio Bags, which shall be made available at Council offices and Libraries for collection free of cost; and
- As per the minutes from the Sustainability Working Party on 5 October 2021, a trial to be undertaken for the supply of 204ltr green waste bins to the residents of Gawler Belt, for the collection of green waste for a period of 12 months at no cost to the residents. after which the service shall become compulsory for the green waste bins for the remaining smaller townships across Council, at the full rate associated for this waste collection service

Land Use Type	Service	Lid Colour	MGB Size
<ul style="list-style-type: none"> <li>• Residential</li> <li>• Dwellings associated with rural properties</li> </ul>	General Waste	Red	140 litre

• Other			
• Commercial • Industrial	General Waste	Red	240 litre
• Residential • Dwellings associated with rural properties Other • Commercial • Industrial	Recycling	Yellow	240 litre
• Residential • Other	Green Organics	Green	240 litre

**Policy Rebates**

Properties receiving a rebate from general rates will need to apply for a separate rebate from the annual service charge. Such rebates may include not for profit community support organisations, service organisations (Lions, Rotary, Apex etc) or educational facilities.

All requests shall be in writing and should outline the reasons why such a rebate should be considered.

**Non-Conforming Waste**

Bins found to be:

- Containing material not compatible with the bins intended purpose; and/or
- Overweight according to the collection contractors weight limits; and/ or
- In a position that prevents the bin from being emptied;

will not be emptied and will need to be rectified prior to the next collection.

**Hard Waste Collection Program**

Council will implement a hard waste kerbside collection and disposal program. The extent and scope of this services will be subject to yearly budget allocations.

**Kapunda Resource Recovery Centre**

Council will operate a resource recovery centre at Kapunda for the collection of green organics, e-waste, waste engine oil, drum muster agricultural chemical drums, scrap metal, paper, cardboard, plastic and glass.

**Disposal Charges**

Charges are itemised in Council's Schedule of Fees and Charges.

**Green Waste Programs**

All non-commercial quantities of green organics will be received free of charge for Light Regional Council ratepayers at the Kapunda Resource Recovery Centre.

**References**



## 6. History of Policy Amendment

Policy adopted 18 July 2006, see Minute Reference 9.2.1, Page 2006/148

1. Policy Amendment No. 1 by Council on 18 September 2007, see Minute Reference 10.3.10, Page 2007/285.
2. Policy Amendment No. 2 by Council on 19 February 2008, see Minute Reference 10.3.7, Page 2008/36.
3. Policy Amendment No. 3 by Council 24 May 2011, see Minute Reference 2-AUD9.5.1/2011 Gawler Belt Kerbside Collection Page 2011/108
4. Policy Amendment No. 4 including name change from Resource Recovery–Kerbside Collection Policy to the new Waste & Recycling Services Policy by Council on 26 November 2013, see Minute Reference I&RS9.5.1/2013, page 2013/356.
5. Policy Amendment No. 5 reviewed by Council on 22 April 2014, see Minute Reference Page 2014/82
6. Policy Amendment No. 6 reviewed by Council on 27 May 2014, see Minute Reference Item 10.5.3 at Page 2014/110
7. Policy Amendment No. 7 reviewed by Council on 22 May 2018, see Minute Reference Page item 12.4.1 at Page 2018/175.
8. Policy Amendment No. 8 adopted by Council on 23 November 2021, Minute Reference IC10.1/2021, Page Reference 2021/239

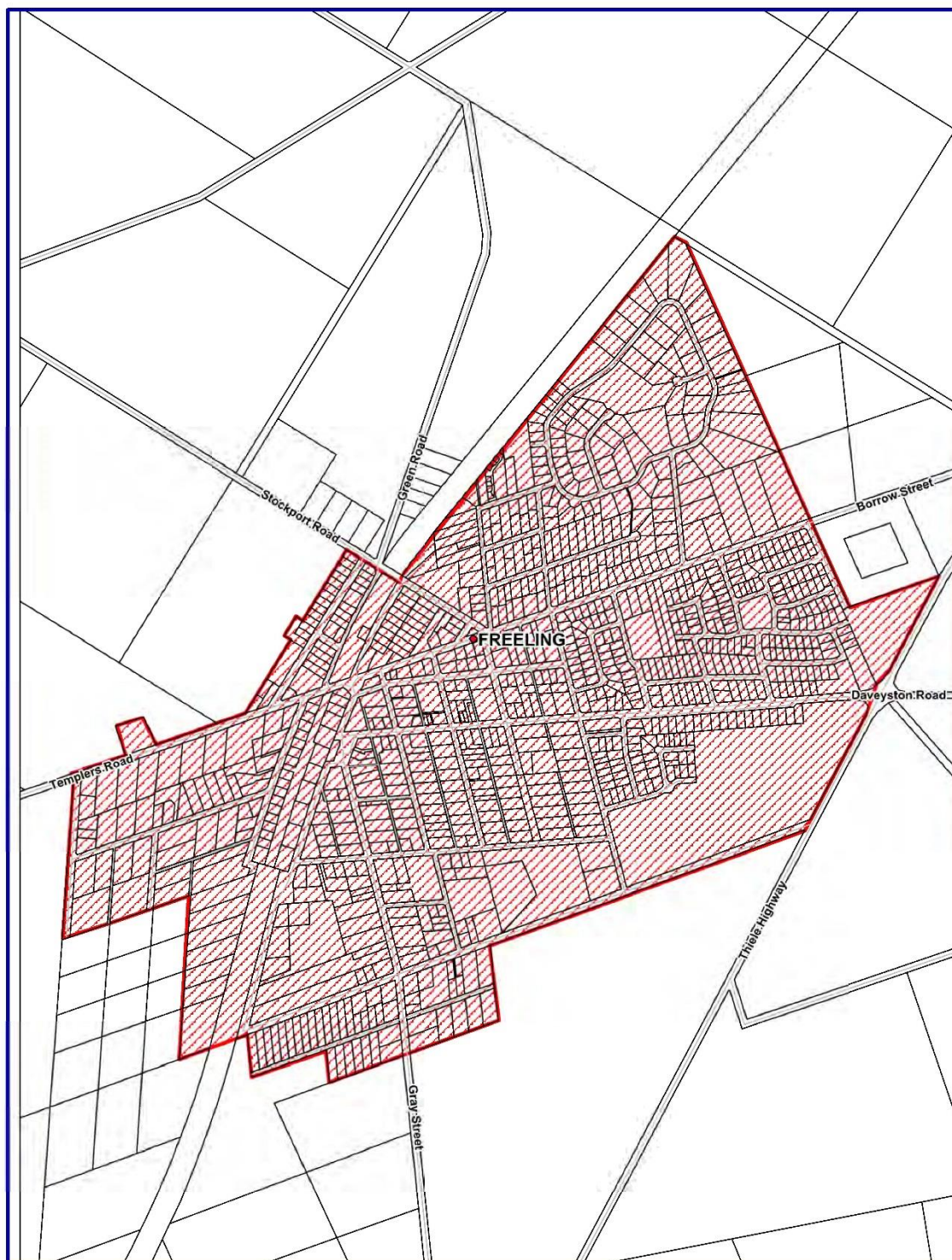

**Light Regional Council**  
PO Box 72, Kapunda, SA 5373  
Telephone (08) 8525 3200  
Facsimile (08) 8566 3262

Printed: 07/04/2014

## Freeling Township Collection Area

Note that: The location of features displayed by the Geographical Information System are for information only and should not be relied upon for absolute position or measurement purposes.

Data Acknowledgements: Cadastral information from Department for Environment, Water & Natural Resources.



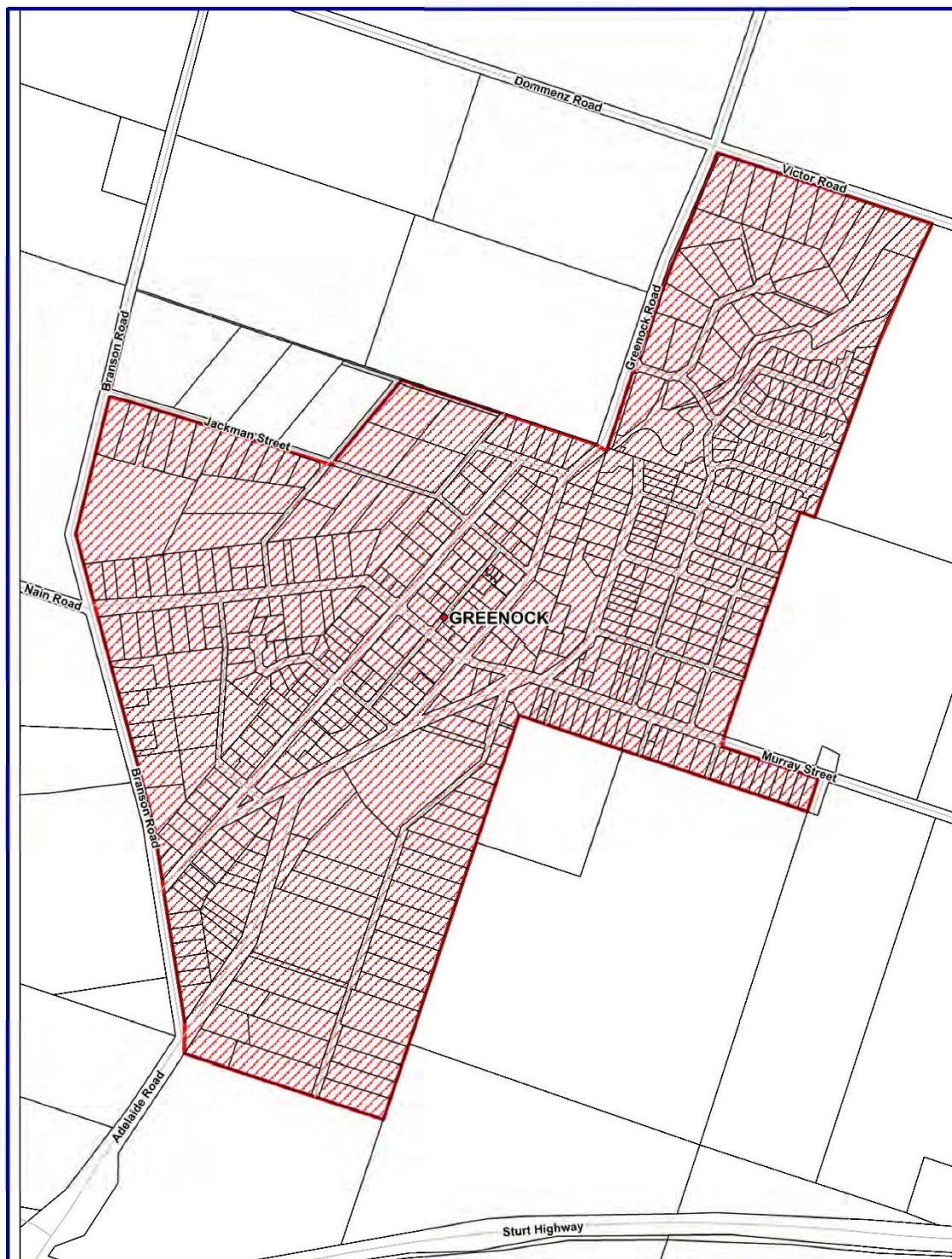

**Light Regional Council**  
 PO Box 72, Kapunda, SA 5373  
 Telephone (08) 8525 3200  
 Facsimile (08) 8566 3262

Light  
Regional  
Council  
 Printed: 07/04/2014

## Greenock Township Collection Area

**Note that:** The location of features displayed by the Geographical Information System are for information only and should not be relied upon for absolute position or measurement purposes

**Data Acknowledgements:** Cadastral information from Department for Environment, Water & Natural Resources

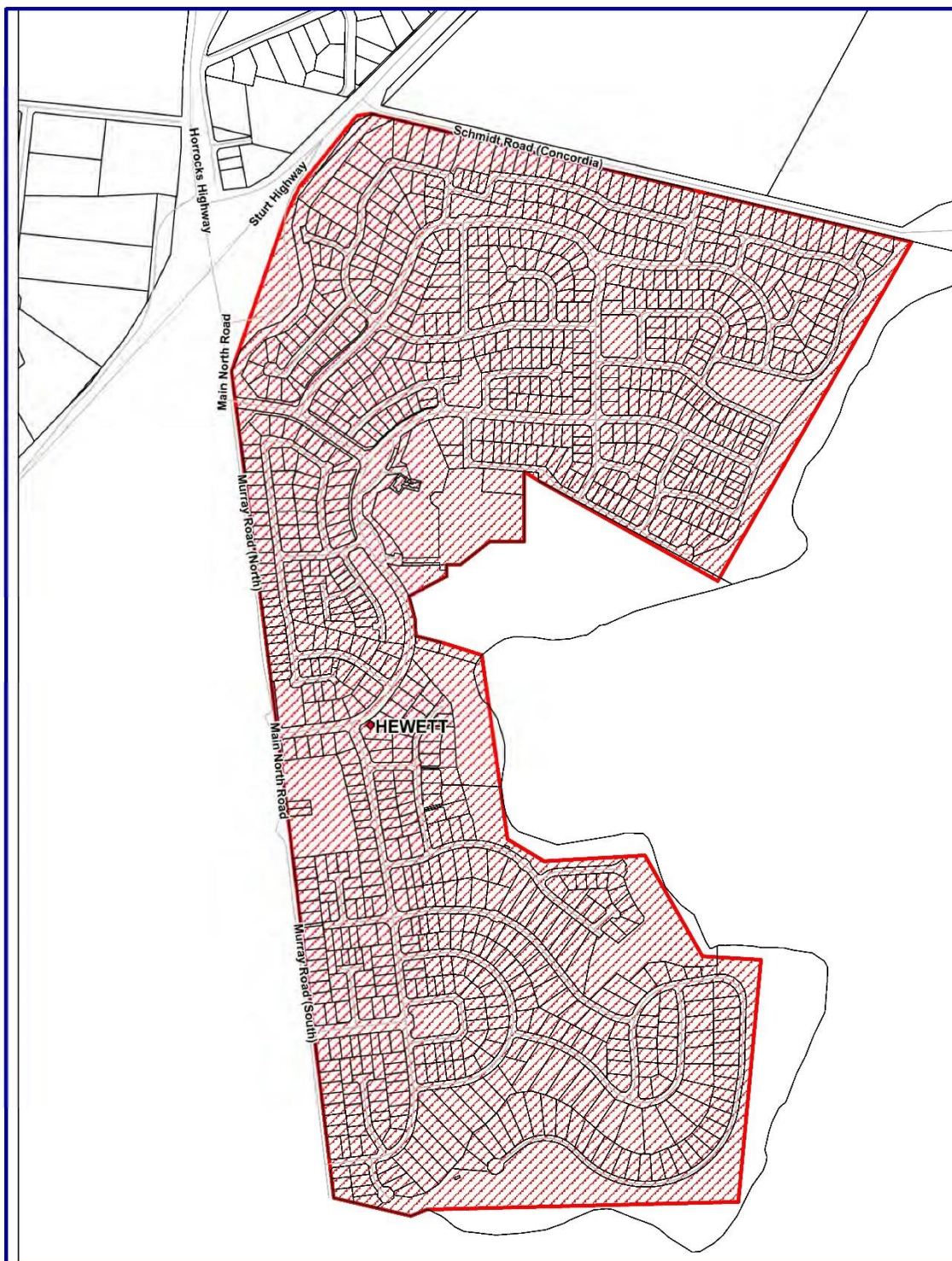

**Light Regional Council**  
 PO Box 72, Kapunda, SA 5373  
 Telephone (08) 8525 3200  
 Facsimile (08) 8566 3262

Printed: 07/04/2014

## Hewett Township Collection Area

Note that: The location of features displayed by the Geographical Information System are for information only and should not be relied upon for absolute position or measurement purposes

Data Acknowledgements: Cadastral information from Department for Environment, Water & Natural Resources



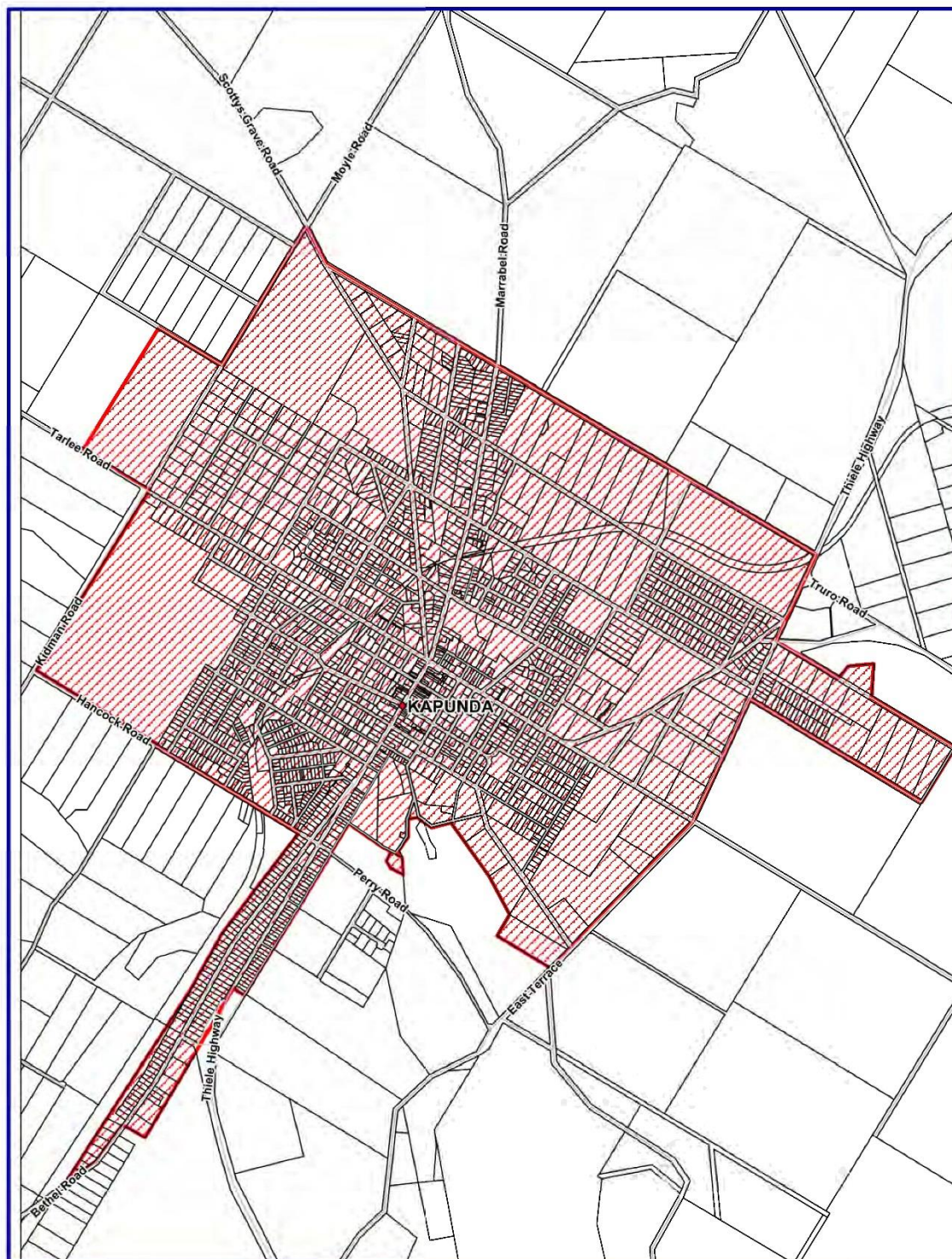

**Light Regional Council**  
 PO Box 72, Kapunda, SA 5373  
 Telephone (08) 8526 3200  
 Facsimile (08) 8566 3262  
 Printed: 07/04/2014

## Kapunda Township Collection Area

**Note that:** The location of features displayed by the Geographical Information System are for information only and should not be relied upon for absolute position or measurement purposes.

**Data Acknowledgements:** Cadastral information from Department for Environment, Water & Natural Resources.

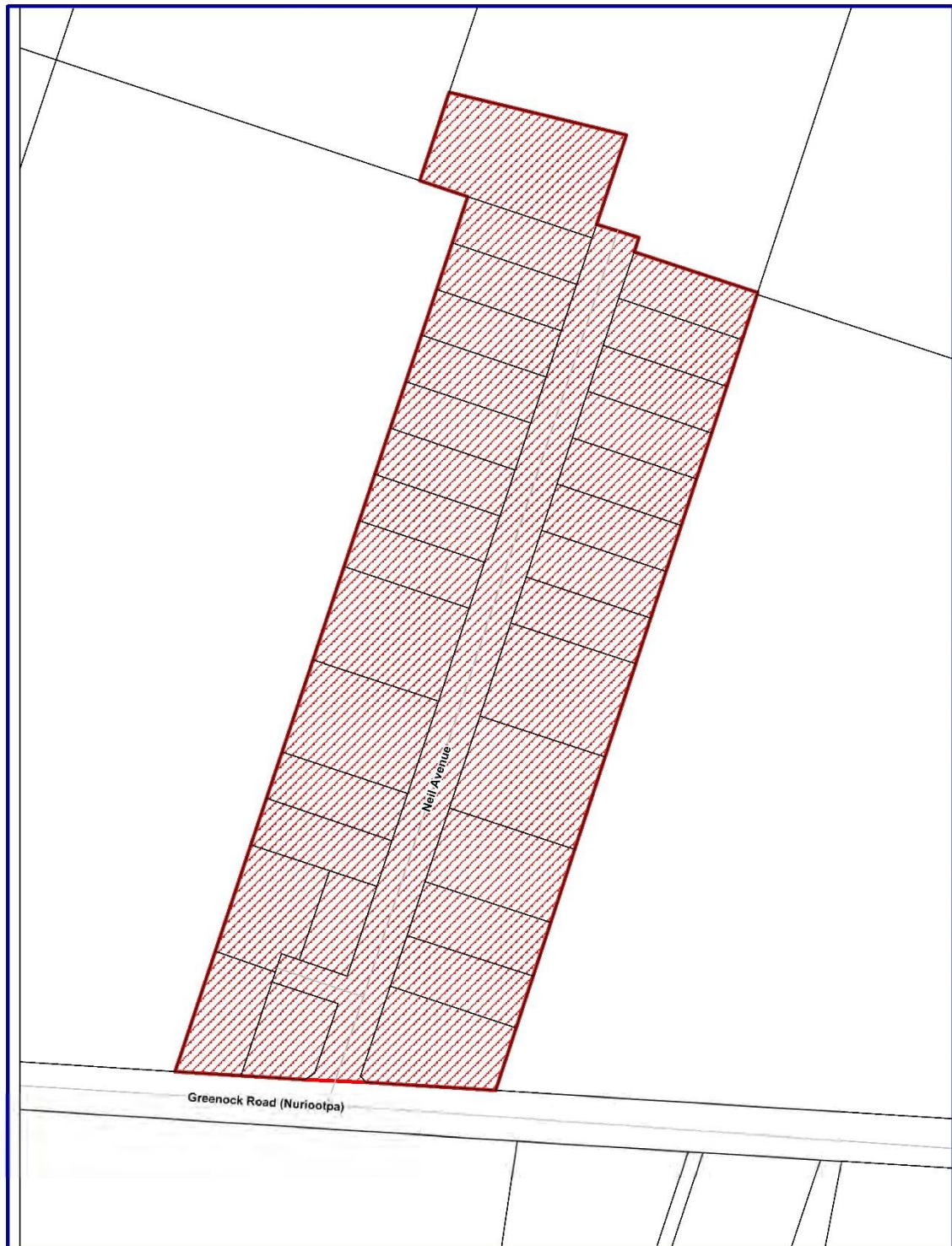

**Light Regional Council**  
 PO Box 72, Kapunda, SA 5373  
 Telephone (08) 8525 3200  
 Facsimile (08) 8586 3262  
 Printed: 07/04/2014

## Nuriootpa Township Collection Area

Note that: The location of features displayed by the Geographical Information System are for information only and should not be relied upon for absolute position or measurement purposes  
 Data Acknowledgements: Cadastral information from Department for Environment, Water & Natural Resources



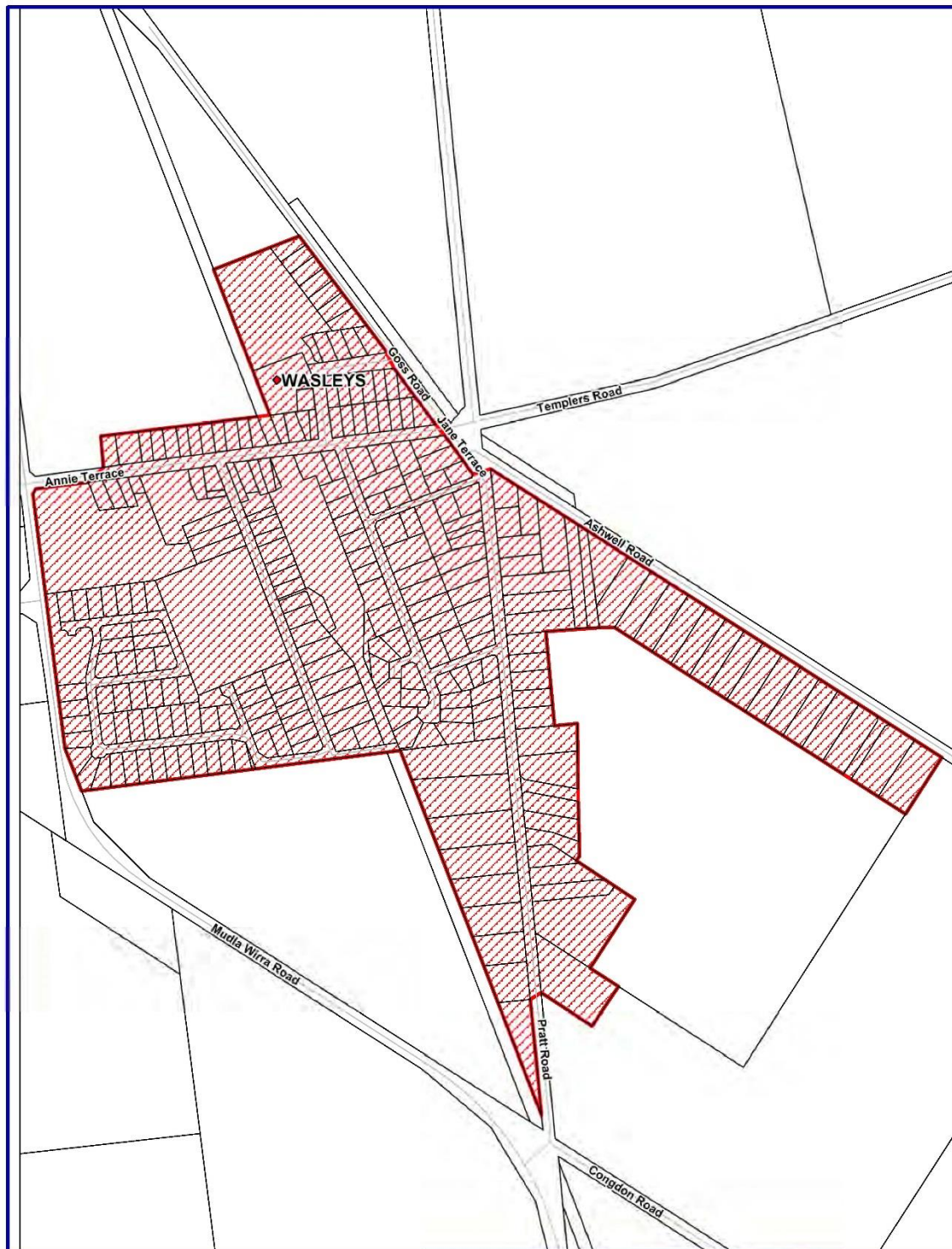

**Light Regional Council**  
 PO Box 72, Kapunda, SA 5373  
 Telephone (08) 8525 3200  
 Facsimile (08) 8566 3262

Printed: 07/04/2014

## Wasleys Township Collection Area

Note that: The location of features displayed by the Geographical Information System are for information only and should not be relied upon for absolute position or measurement purposes

Data Acknowledgements: Cadastral information from Department for Environment, Water & Natural Resources

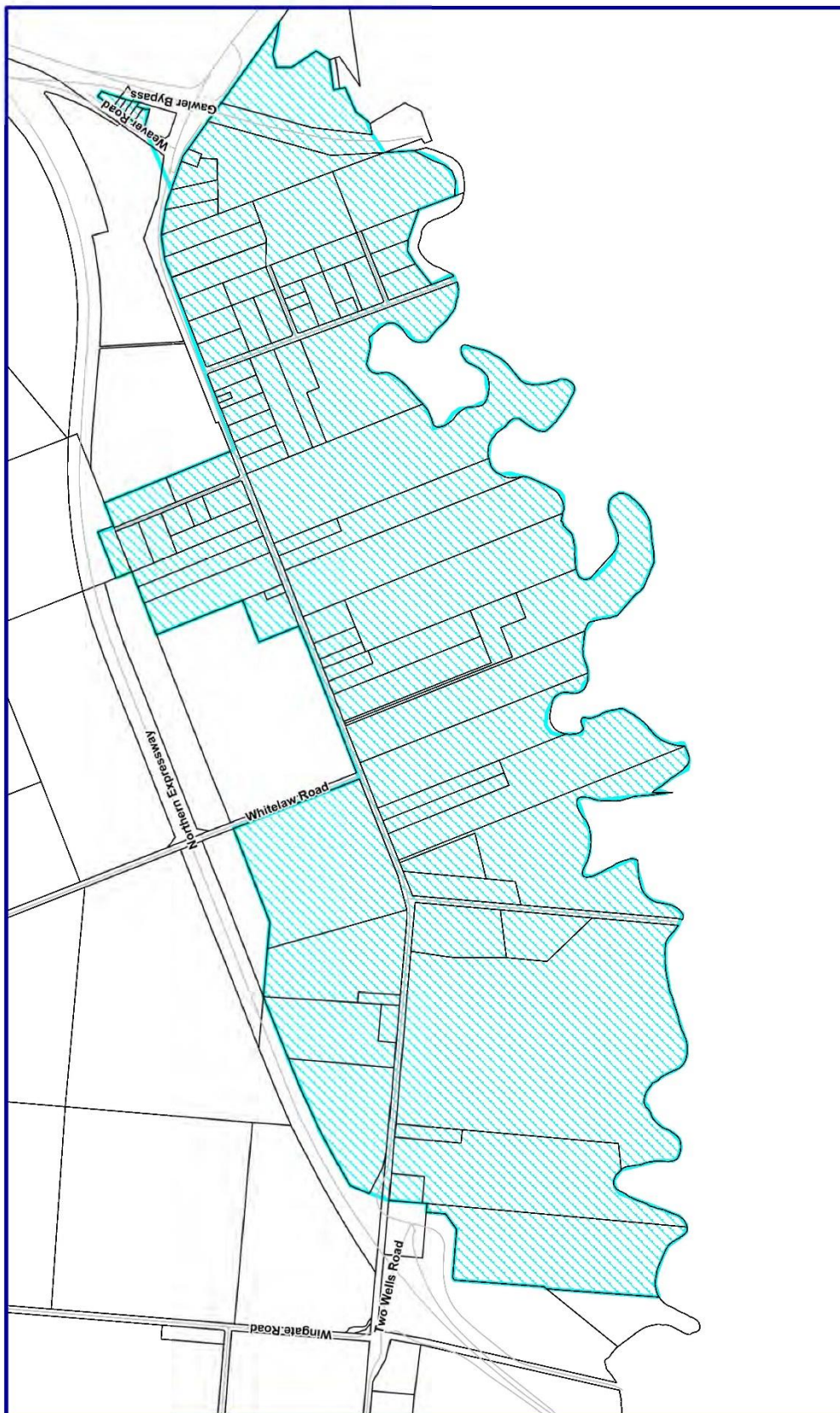

**Light Regional Council**  
 PO Box 72, Kapunda, SA 5373  
 Telephone (08) 8525 3200  
 Facsimile (08) 8566 3262  
 Printed: 07/04/2014



## Buchfelde Rural Collection Area

Note that: The location of features displayed by the Geographical Information System are for information only and should not be relied upon for absolute position or measurement purposes.

Data Acknowledgements: Cadastral information from Department for Environment, Water and Heritage

APPENDIX COUNCIL 12.3B-22MAY2018

PAGE 1

AGENDA ITEM COUNCIL 12.4.1



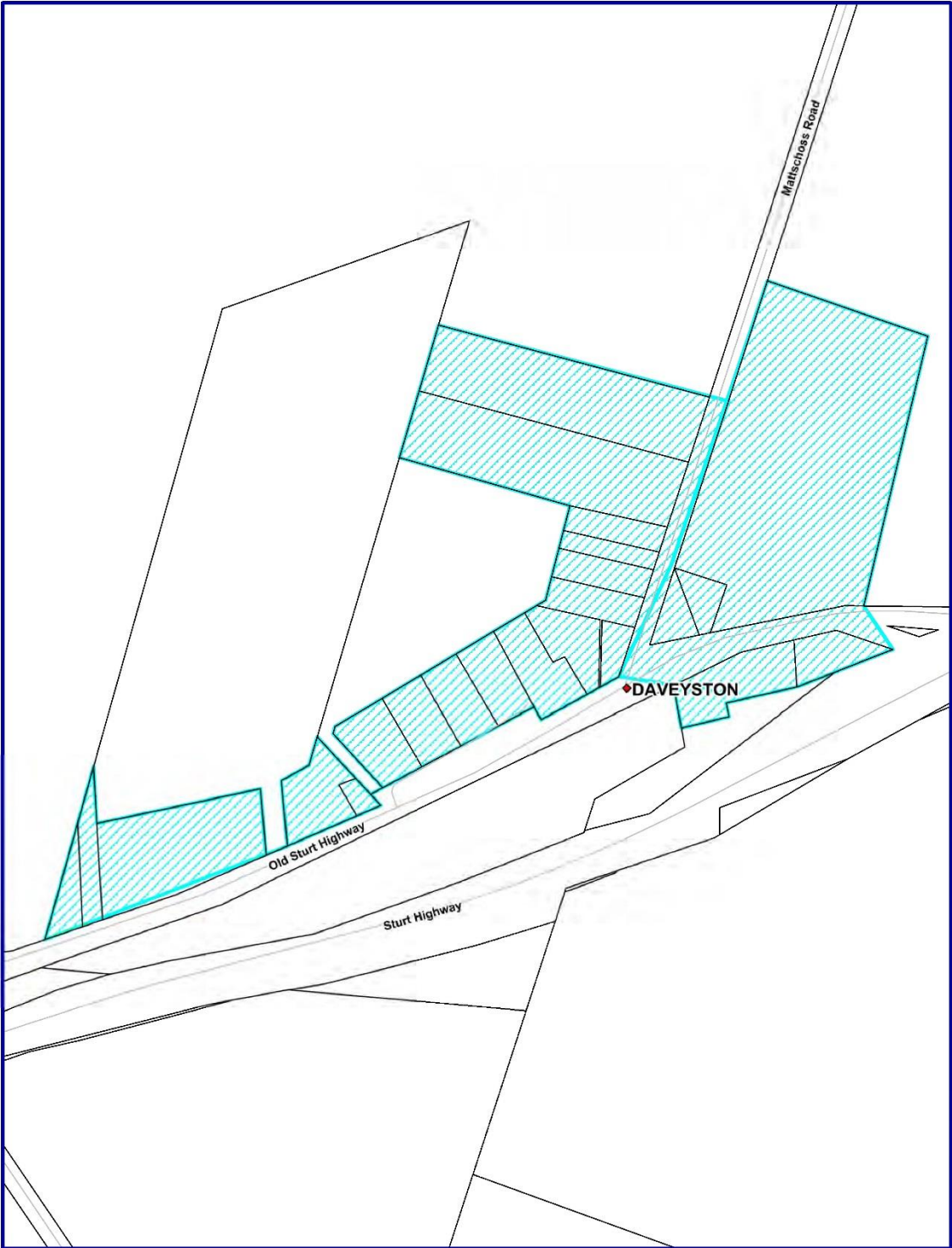

Light Regional Council  
PO Box 72, Kapunda, SA 5373  
Telephone (08) 8525 3200  
Facsimile (08) 8566 3262  
Printed: 07/04/2014

Daveyston Rural  
Collection Area

**Note that:** The location of features displayed by the Geographical Information System are for information only and should not be relied upon for absolute position or measurement purposes  
**Data Acknowledgements:** Cadastral information from Department for Environment, Water & Natural Resources



**Light Regional Council**  
 PO Box 72, Kapunda, SA 5373  
 Telephone (08) 8525 3200  
 Facsimile (08) 8566 3262

Printed: 07/04/2014

## Gawler Belt Rural Industrial Collection Area

Note that: The location of features displayed by the Geographical Information System are for information only and should not be relied upon for absolute position or measurement purposes

Data Acknowledgements: Cadastral information from Department for Environment, Water & Natural Resources



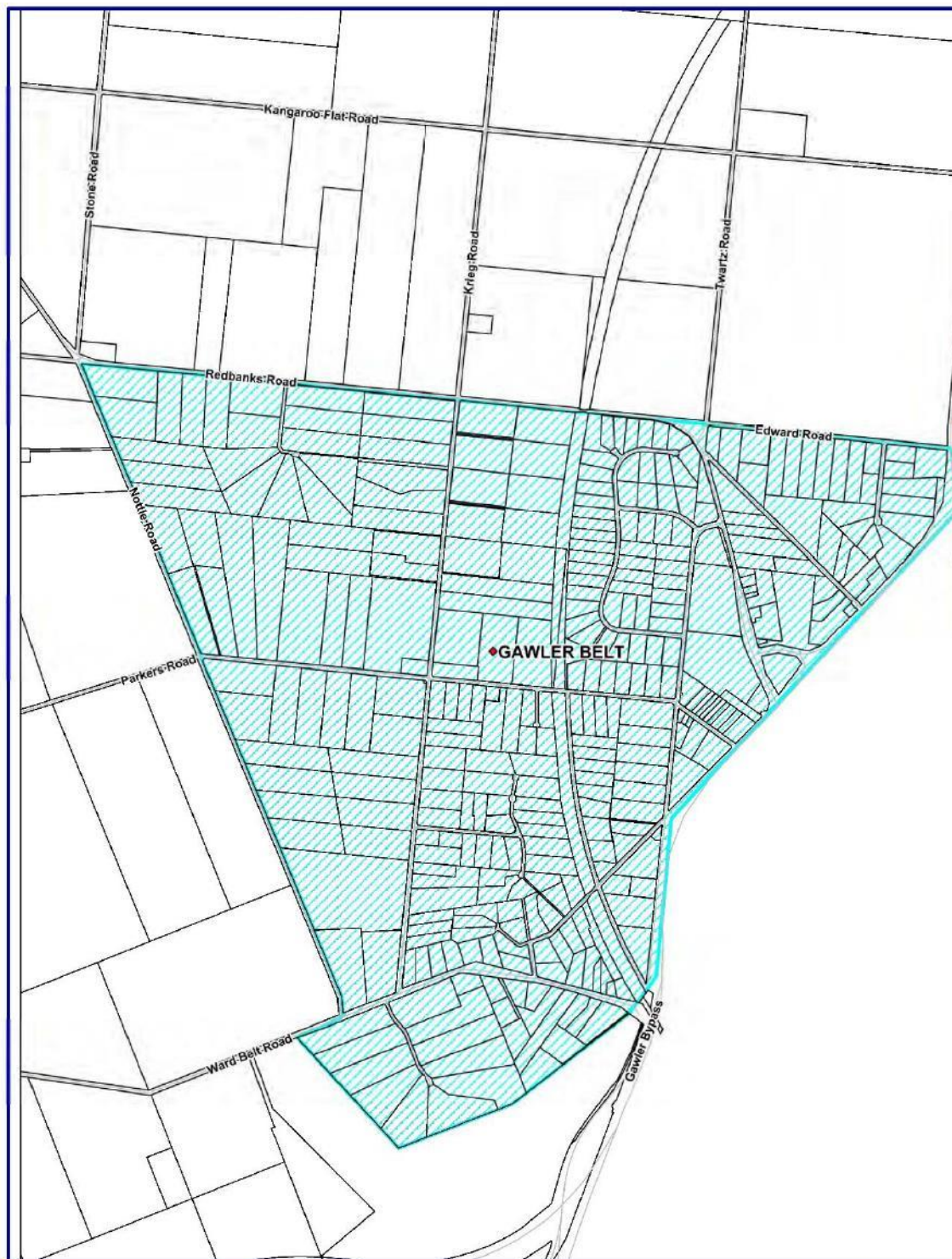

Light Regional Council  
PO Box 72, Kapunda, SA 5373  
Telephone (08) 8526 3200  
Facsimile (08) 8566 3262

Printed: 07/04/2014

### Gawler Belt Rural Collection Area

Note that: The location of features displayed by the Geographical Information System are for information only and should not be relied upon for absolute position or measurement purposes.  
Data Acknowledgements: Cadastral information from Department for Environment, Water & Natural Resources

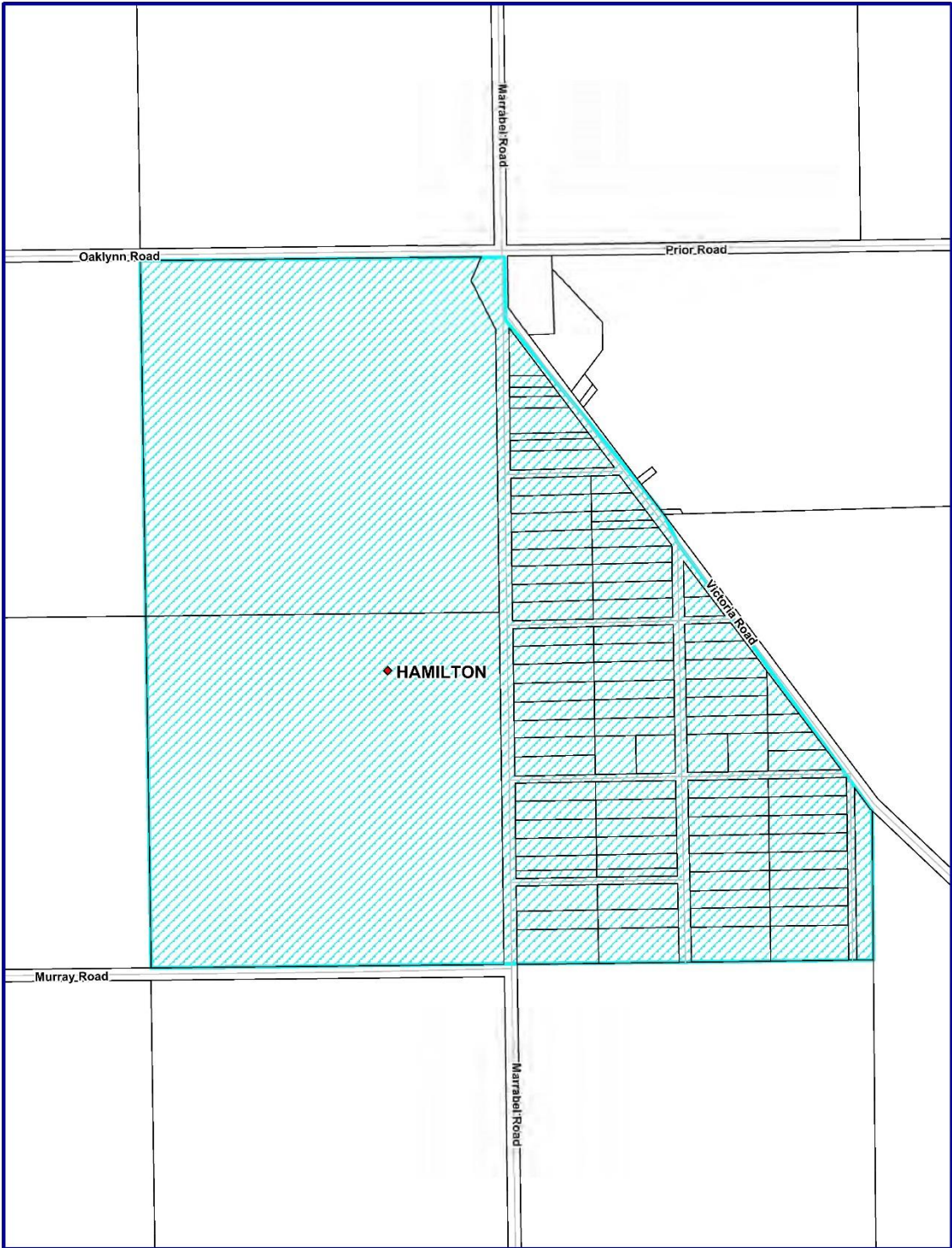

Light Regional Council  
PO Box 72, Kapunda, SA 5373  
Telephone (08) 8526 3200  
Facsimile (08) 8566 3262  
Printed: 07/04/2014

Hamilton Rural  
Collection Area

Note that: The location of features displayed by the Geographical Information System are for information only and should not be relied upon for absolute position or measurement purposes  
Data Acknowledgements: Cadastral information from Department for Environment, Water & Natural Resources





**Light Regional Council**  
 PO Box 72, Kapunda, SA 5373  
 Telephone (08) 8525 3200  
 Facsimile (08) 8566 3262  
 Printed: 07/04/2014

## Roseworthy Rural Collection Area

Note that: The location of features displayed by the Geographical Information System are for information only and should not be relied upon for absolute position or measurement purposes

Data Acknowledgements: Cadastral information from Department for Environment, Water & Natural Resources

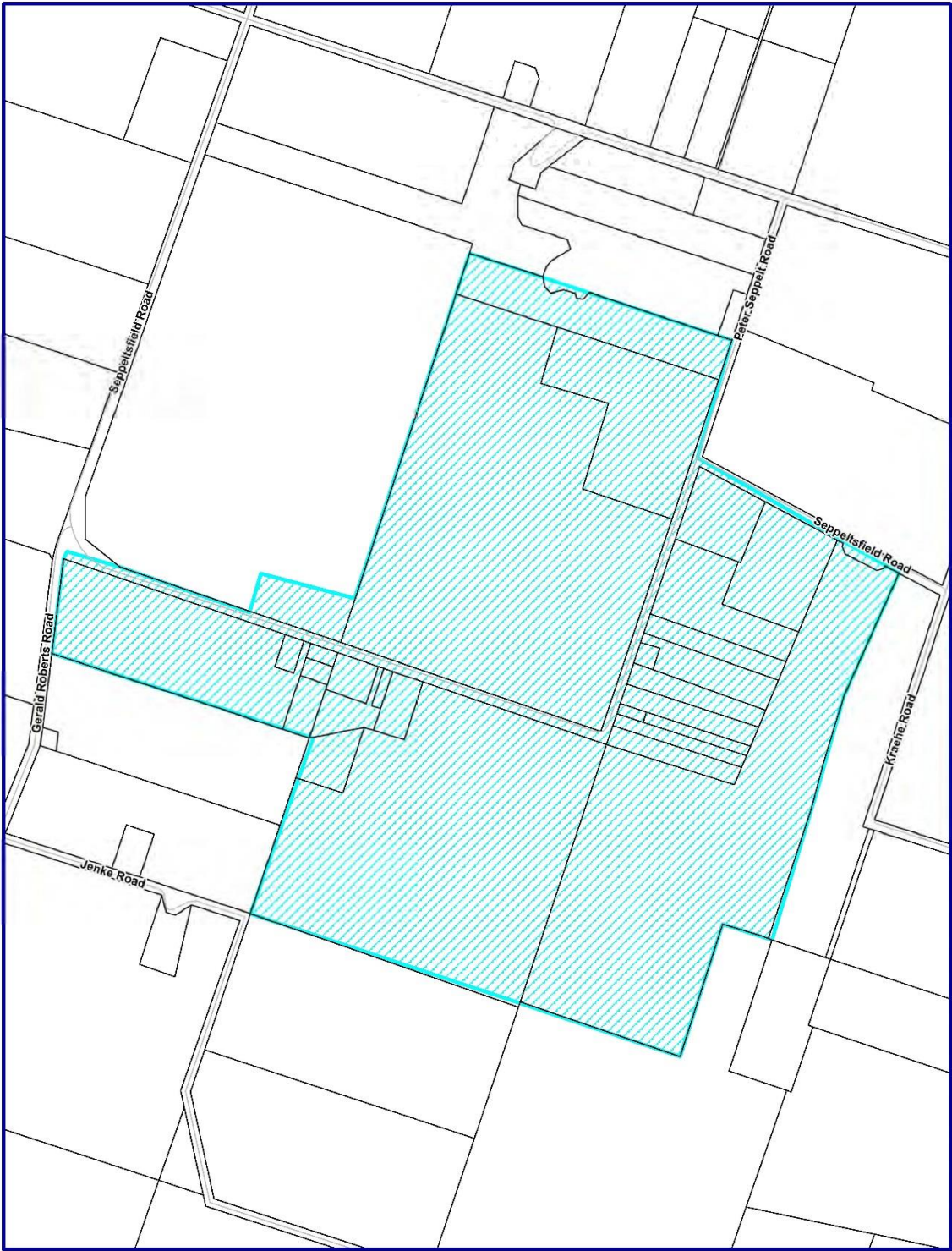

**Light Regional Council**  
PO Box 72, Kapunda, SA 5373  
Telephone (08) 8525 3200  
Facsimile (08) 8566 3262  
Printed: 07/04/2014

**Seppeltsfield Rural  
Collection Area**

**Note that:** The location of features displayed by the Geographical Information System are for information only and should not be relied upon for absolute position or measurement purposes  
**Data Acknowledgements:** Cadastral information from Department for Environment, Water & Natural Resources



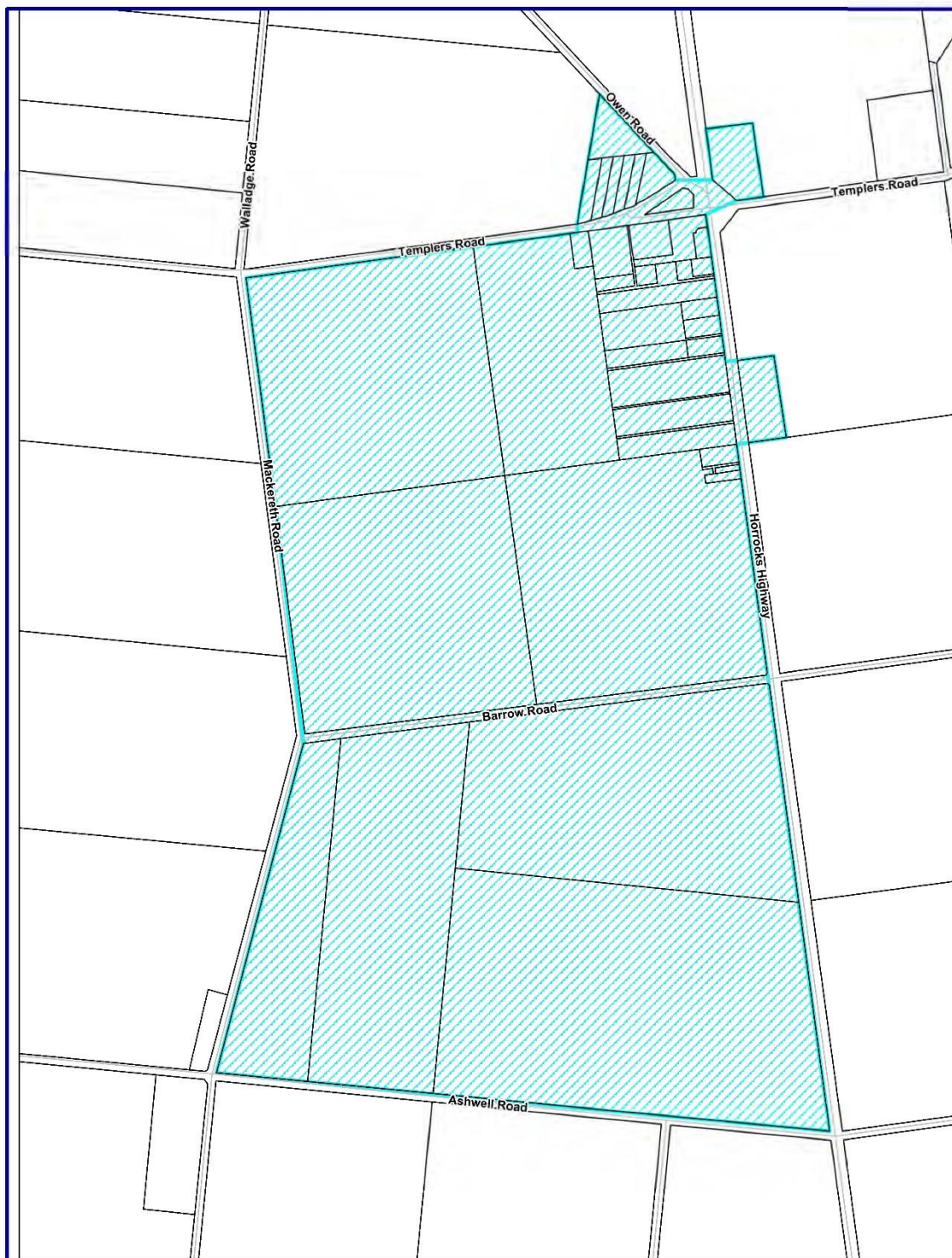

**Light Regional Council**  
 PO Box 72, Kapunda, SA 5373  
 Telephone (08) 8526 3200  
 Facsimile (08) 8566 3262  
 Printed: 07/04/2014

## Templers Rural Collection Area

Note that: The location of features displayed by the Geographical Information System are for information only and should not be relied upon for absolute position or measurement purposes

**Data Acknowledgements:** Cadastral information from Department for Environment, Water & Natural Resources

yed  
are  
ed  
it  
  
ent,

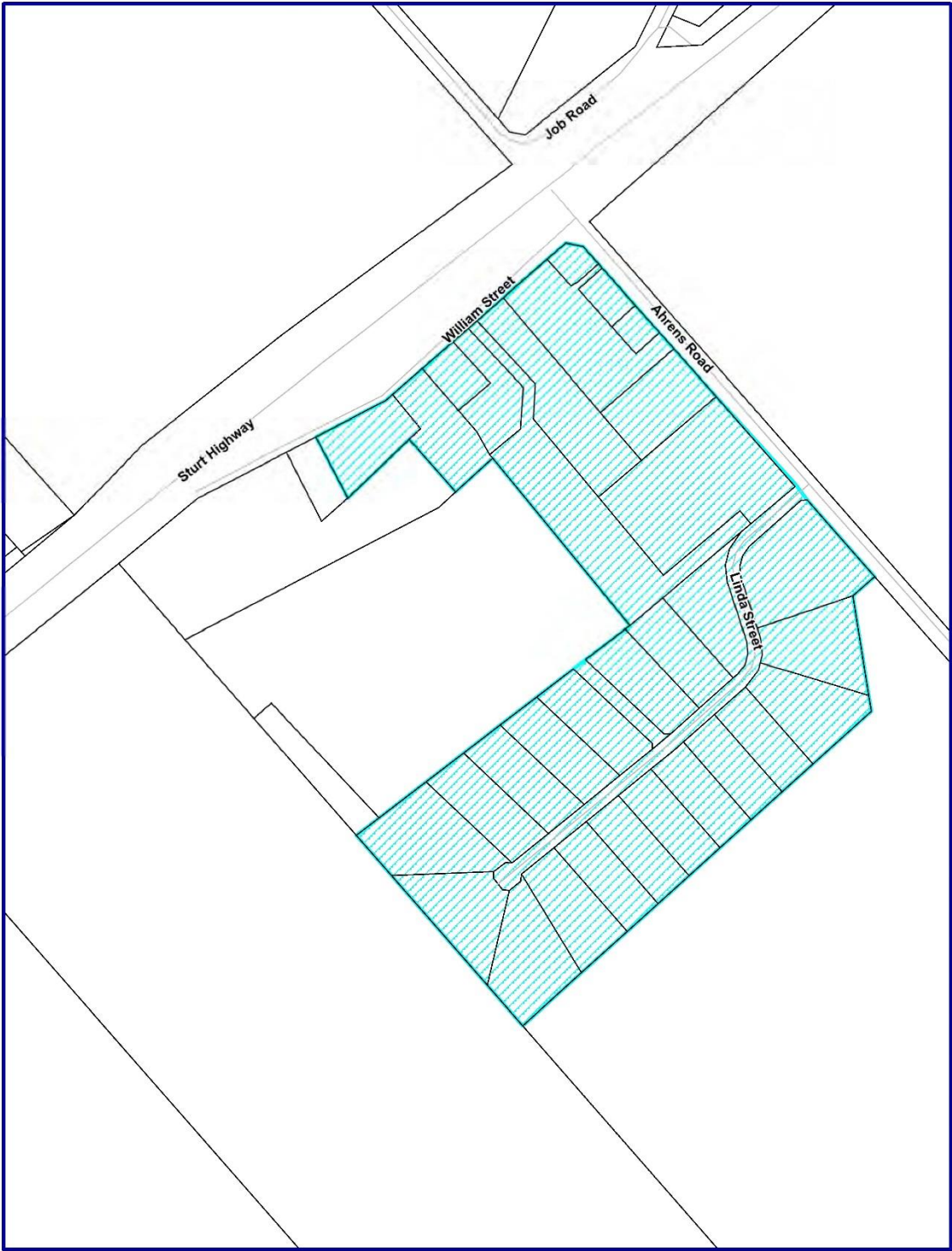

**Light Regional Council**  
PO Box 72, Kapunda, SA 5373  
Telephone (08) 8525 3200  
Facsimile (08) 8566 3262  
Printed: 16/04/2014

**Shea-Oak Log Rural  
Collection Area**

**Note that:** The location of features displayed by the Geographical Information System are for information only and should not be relied upon for absolute position or measurement purposes  
**Data Acknowledgements:** Cadastral information from Department for Environment, Water & Natural Resources